



Cleaning Instructions for Humidifiers with HydroCore™

Hard Water Installation*

Annual replacement of the orifice and cleaning of the valve is required to maintain optimal performance.

Soft or Softened Water Installation*

Replace the orifice and clean the valve
every 3 years or as needed based on usage.

*To determine water connection, trace the water inlet (L) back to the water source to see if it is connected to a softener or contact your service technician. Itchy skin, poor soap lather, and mineral residue or buildup on faucets or appliances are signs of hard water.

WARNING: Take note of humidifier control setpoint and turn dial to off position before starting.

1. Remove cover (A) by depressing latch (B) and pulling away from base (C). Remove HydroCore (D) then brush away any mineral deposits from the base.
2. Plug the drain port (E) or raise the end of the flexible drain line (F) above the valve and secure to create a trap.
3. Pour white vinegar into the valve cup (G) up to the clean line (H). Soak for up to 30 minutes.
4. Use a small plastic bristle brush to remove buildup in the valve cup then drain vinegar solution. Flush with water.
5. Replace the rubber seal cap (I) and orifice (J) assembly (PN: 70000037). See **Orifice Replacement Instructions**.
6. If applicable, remove the drain line and flex it to loosen any mineral deposits or blockages then flush with water. **ensuring it has a constant downward slope and is not flattened or blocked.**
7. Install fresh HydroCore and test to confirm proper function.

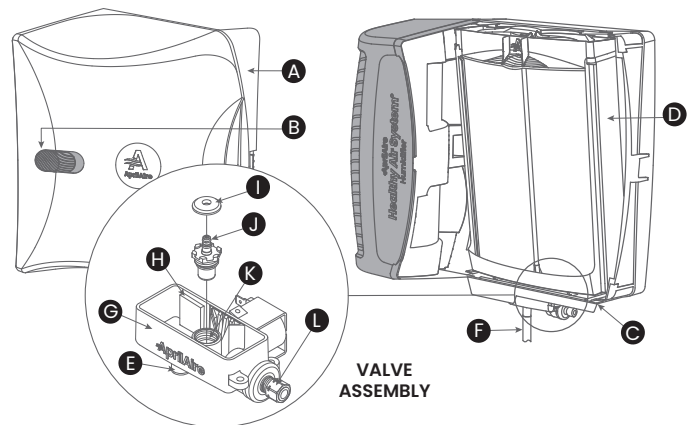

- | | |
|----------------|--------------------|
| A. COVER | G. VALVE CUP |
| B. LATCH | H. CLEAN LINE |
| C. BASE | I. RUBBER SEAL CAP |
| D. HYDROCORE L | J. ORIFICE |
| E. DRAIN PORT | K. ORIFICE CAVITY |
| F. DRAIN LINE | L. WATER INLET |

NOTE: Inlet strainer is designed to last for the life of the solenoid valve assembly and should not be removed from the water inlet (L).

Orifice Replacement Instructions REQUIRED ANNUALLY FOR HARD WATER

1. Remove rubber seal cap (I) from the orifice (J).
2. Using an 11/16" socket or adjustable wrench, turn the orifice counterclockwise to carefully loosen and remove it from the valve assembly. Ensure no debris enters the orifice cavity (K).
3. Insert the new orifice, turn clockwise to tighten (finger-tight plus 1/8 to 1/4 turn-do not over-tighten), and press the rubber seal cap onto the orifice.



(Included with Hard Water Kit)

Contact AprilAire
Technical Support
for details:
800.334.6011