

Project: _____

Dealer: _____

Architect: _____

Engineer: _____

Contractor: _____

Location: _____

Suppliers: _____

Date: _____

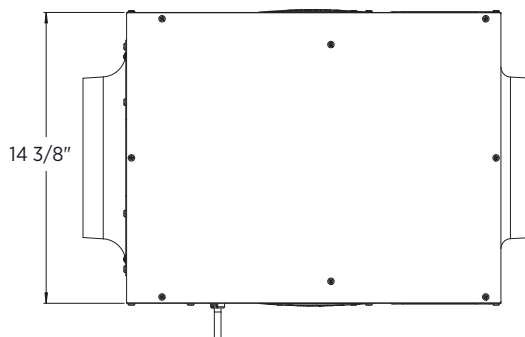
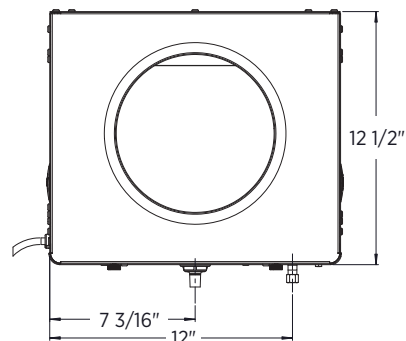
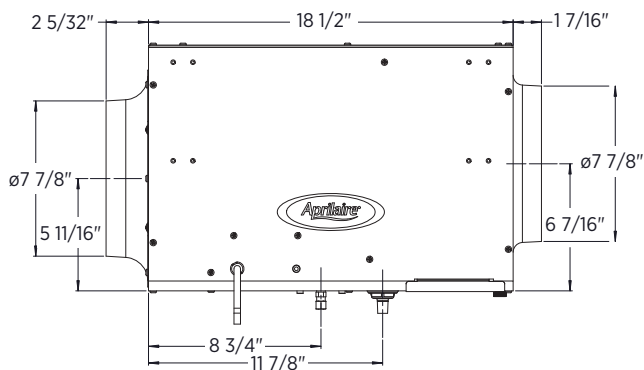

Capacity:	13 gpd in homes up to 3,500 sq ft with tight construction*
Water Feed Rate(gph):	6
Required Water Temperature:	120°F to 140°F
Minimum Supply Air Temperature:	65°F
Ambient Temperature Operating Range:	65°F - 120°F

Electric Characteristics:	
• Solenoid Valve:	24VAC
• Control Voltage:	24VAC
• Primary Voltage:	120VAC/1 phase/60HZ
Cabinet Construction:	20 Gauge, Galvannealed Cold Rolled Steel
Cabinet Finish Color:	Gray
Shipping Weight:	38.25 lbs.

*Based on AHRI Guideline F Humidifier Sizing. Can satisfy a 2,000 sq ft home with average construction.

The submittal is intended to show general, overall product dimensions and provide guidance for installation clearance. Drawings are not to scale. Ensure submittals are current. Research Products reserves the rights to make product change without notifications or obligations.