

### ROUND DAMPER

#### FLEX LINK REPLACEMENT INSTRUCTIONS (SEE FIGURE 1)

1. Remove plastic motor cover.
2. Remove screw(s) that attach motor to assembly.
3. Remove motor and let it hang by the power wires.
4. Remove the screw(s) that attach the motor bracket to the assembly.
5. Disconnect the Flex Link from the black drive spool and the lever arm. Use care to prevent the lever arm from disengaging from the metal shaft.
6. Install the small cog of the new Flex Link into the drive spool and the large cog into the lever arm.
7. Re-install the motor support base to the assembly and secure with the original screw(s).
8. Align the flat on the motor drive shaft with the flat in the drive spool and insert the shaft into the spool.
9. Rotate the motor as required to line up the motor mounting hole(s) with the support base and secure with the original screw(s).
10. Re-install the plastic motor cover.

FIGURE 1 – Round Damper

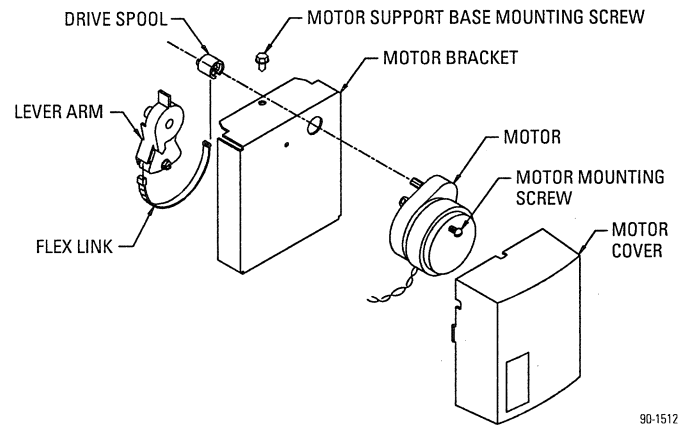

90-1512

### OLD RECTANGULAR DAMPER

#### FLEX LINK REPLACEMENT INSTRUCTIONS (SEE FIGURE 2)

1. Remove plastic motor cover.
2. Remove screw(s) that attach motor to assembly with a Phillips screwdriver.
3. Remove motor and let it hang by the power wires.
4. Remove screws mounted to the duct work.
5. Remove the screw(s) that attach the face plate to the assembly.
6. Disconnect the Flex Link from the black drive spool and the lever arm. Use care to prevent the lever arm from disengaging from the bearing.
7. Re-install drive spool into location hole in assembly.
8. Install the small cog of the new Flex Link into the drive spool and the large cog into the lever arm.
9. Re-install the face plate to the assembly and secure with the original screw(s).
10. Align the flats on the motor drive shaft with the flats in the drive spool and insert the shaft into the spool.
11. Rotate the motor as required to line up the motor mounting hole(s) with the face plate and secure with the original screw(s).
12. Re-install the plastic motor cover.

FIGURE 2 – Old Rectangular Damper

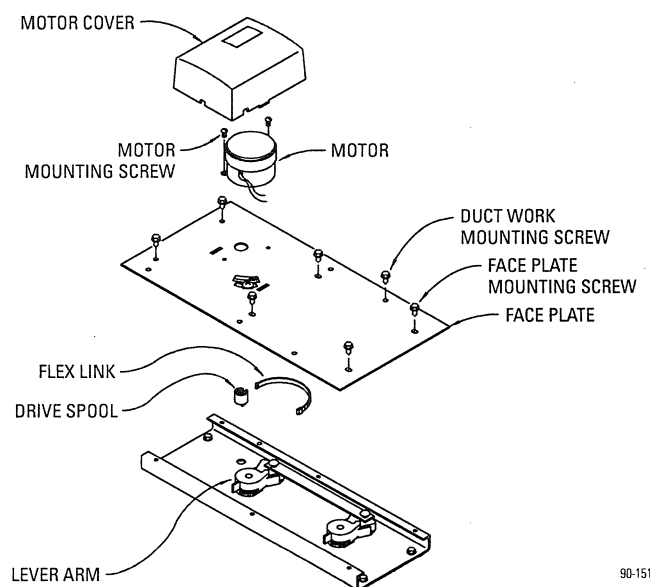

90-1512

## NEW RECTANGULAR DAMPER

### FLEX LINK REPLACEMENT INSTRUCTIONS (SEE FIGURE 3)

1. Remove plastic motor cover and pull off open - closed indicator.
2. Remove screws that attach motor to assembly and one screw next to motor with a Phillips screwdriver.
3. Remove motor and let it hang by the power wires.
4. Remove screws mounted to the duct work.
5. Remove the screws that attach the face plate to the assembly.
6. Disconnect the Flex Link from the drive spool and the lever arm. Use care to prevent the lever arm from disengaging from the bearing.
7. Re-install drive spool into location hole in assembly.
8. Install the small cog of the new Flex Link into the drive spool and the large cog into the lever arm.
9. Re-install the face plate to the assembly and secure with the original screw(s).
10. Align the flats on the motor drive shaft with the flats in the drive spool and insert the shaft into the spool.
11. Rotate the motor as required to line up the motor mounting hole(s) with the face plate and secure with the original screw(s).
12. Re-install the plastic motor cover and open - closed indicator.

FIGURE 3 – New Rectangular Damper

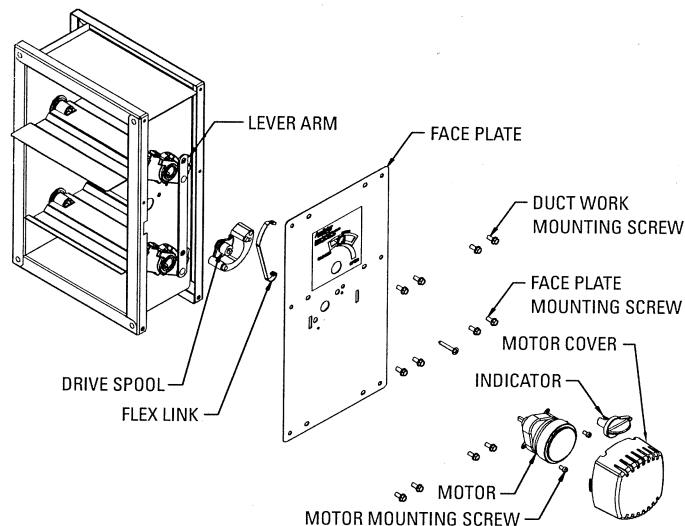

90-1512

RESEARCH PRODUCTS CORPORATION

P.O. Box 1467 • Madison, WI 53701-1467 • Phone: 800/334-6011 • Fax: 608/257-4357 • [www.aprilairepartners.com](http://www.aprilairepartners.com)